

PROPOSED (LOWER GROUND+GROUND +5) STORIED RESIDENTIAL BUILDINGS ON R.S PLOT NO--589(P) &592(P) OF MOUZA-KAUSHALYA, J.L. NO-311, WITHIN KHARAGPUR MUNICIPAL AREA AND R.S. PLOT NO-565(P) &566(P), MOUZA-MIRPUR, J.L. NO-240, WITHIN GOPALI G.P. DIST.- PASCHIM MEDINIPUR,

UNDER JURISDICTION KHARAGPUR MUNICIPALITY AREA-12.18 DEC(746.02 SQM)
 UNDER JURISDICTION PANCHAYAT AREA-18.33 DEC(496.85 SQM)
 TOTAL AREA 30.51 DEC(1242.87 SQM)

TOTAL AREA OF THE PLOT - 1242.87 SQM
 GROUND COVERAGE ALLOWED- 50%
 GROUND COVERAGE PROPOSED- 49.87%
 =619.82
 HEIGHT OF BUILDING- 20M
 SETBACKS TAKEN
 FRONT 3.5M
 SIDE-1.4 M
 SIDE-2.4 M
 REAR 5 M
 PROPOSED HEIGHT 20M

OWNER'S NAME

1. SRI PRABHAT KR SINGH
 S/O LT PURNA CH SINGH

2. SMT MANITA SINGH
 W/O SRI PRABHAT KR SINGH

3. KUMARI SARMISTHA
 U/G SRI PRABHAT KR SINGH

Sharmistha Singh

A. R. BANERJEE
 CIVIL ENGINEER
 Khargpur Municipality
 LICENCE No-KM-17-18/01

AR. SUBHASISH DEY
 Reg. No.-CA/2019/7074
 INCEPTIVE ARCHITECTS &
 ARTECH ARCHITECTS
 Signature of Architect :

It may be sanctioned on terms and Condition given by the Surveyor
 Asst. Engineer
 Khargpur Municipality
 SANCTIONED ON TERMS & CONDITION GIVEN BY SURVEYOR & A.E
 CHAIRMAN / VICE CHAIRMAN

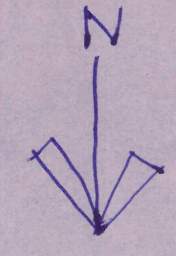
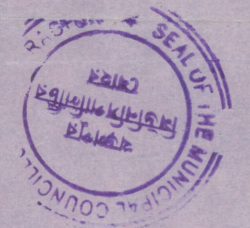

Double Stored Building
 Double Stored Building
 Single Stored Building
 Single Stored Building
 Single Stored Building
 Double Stored Building

19.42 M WIDE ROAD

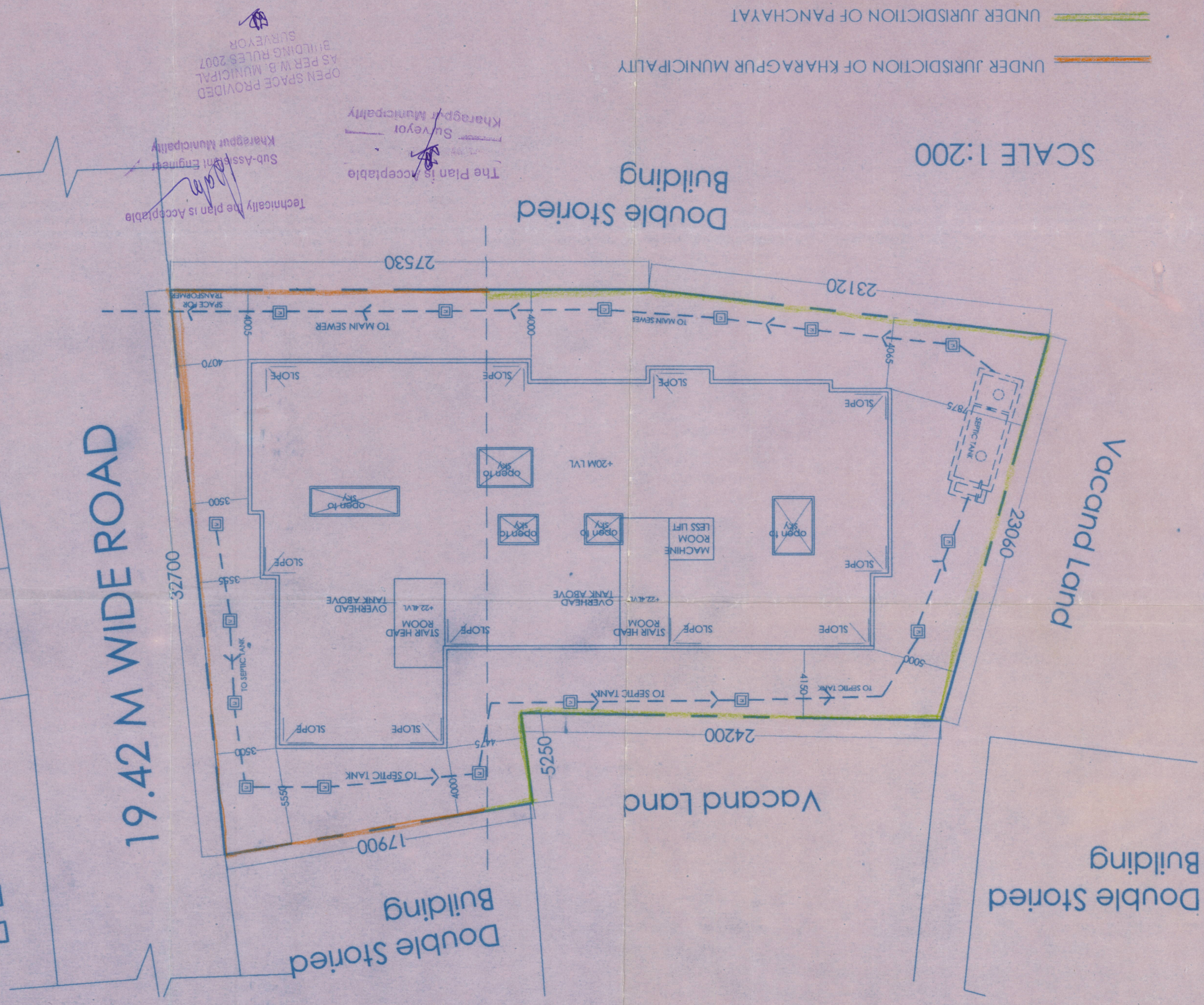

SCALE 1:200

UNDER JURISDICTION OF KHARAGPUR MUNICIPALITY
 UNDER JURISDICTION OF PANCHAYAT

The Plan is Acceptable
 Khargpur Municipality
 Sub-Assistant Engineer
 Khargpur Municipality
 Technically the plan is Acceptable

OPEN SPACE PROVIDED AS PER W.B. MUNICIPAL BUILDING RULES 2007
 SURVEYOR